

Carbon Monoxide Detector

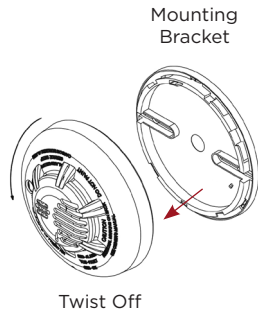

- 1 Twist the mounting bracket away from the main unit.
- 2 Use the two provided screws to mount the bracket to the wall or ceiling.

- » Wall-mounted detectors should be positioned at least as high as a light switch and at least six inches from the ceiling. In a ceiling location, the detector should be at least 12 inches from any wall.
- » Mount within 10 feet of a sleeping area.
- » Mount on every floor of the building.
- » Ideally, install in any room that contains a fuel burning appliance.
- » If the appliance or the room is not normally used, such as the boiler room, the detector should be placed just outside the room so the alarm can be heard more easily.

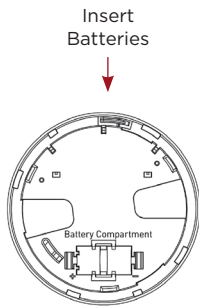

- 3 Insert the batteries.
- 4 Twist the carbon monoxide panel back onto the mounting plate.

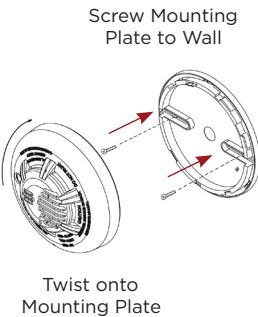

- 5 This product has an approximate life span of 7 years and should be replaced at such time. Actual life span varies based on environmental conditions and some detectors may need to be replaced sooner. Test detectors weekly and replace batteries as needed.